

PLUS OPTIMA UNBRAKED AXLE

Modern, maintenance-free axle technology "Made in Germany"

THE ADVANTAGES FOR YOU

Hollow swing arm for greater ride comfort. The lightweight link is produced with maximum quality in the latest production facilities.



CONTINUOUSLY WATERTIGHT COMPACT BEARING FOR BOAT TRAILERS (OPTION)

The seal is achieved directly **in the Compact bearing** by radial shaft seals with tried-and-tested AL-KO quality.



HUB VARIANTS AND POSSIBLE WHEEL CONNECTIONS

| | Offset from - to mm | Additional weight per axle | Possible wheel connections | | | | | | | | | | | |
|----------------------|---------------------|----------------------------|----------------------------|------|---------|-------|-------|---------|-------|-------|-------|---------|-------|-------|
| | | | 100x4 | 98x4 | 101.6x4 | 115x4 | 130x4 | 139.7x4 | 108x4 | 108x5 | 112x5 | 114.3x5 | 120x5 | 130x5 |
| Standard hub | 27-45 | | x | x | x | | | | | | | | | |
| Universal hub | 27-45 | 2.8 kg | | | | x | x | x | x | x | x | x | x | x |

If the offset values are exceeded or undershot, the bearing service life will be reduced.

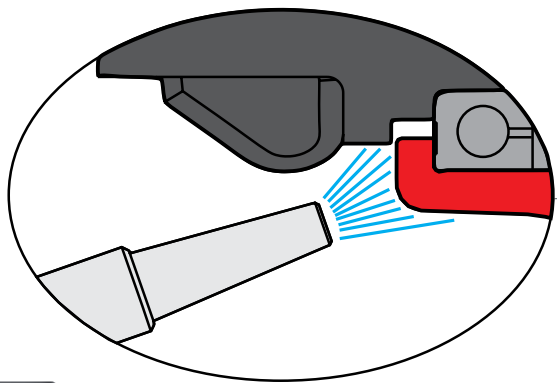

HUB WITH INTEGRATED SPLASH GUARD AND IMPACT PROTECTION

- | The bearing is protected by the shape of the hub and the axle stub
- | This means dirt and dust cannot act directly on the bearing
- | When cleaning with a high-pressure cleaner, the water jet does not act directly on the bearing



MAINTENANCE-FREE COMPACT BEARING AS STANDARD

- | Fill-for-life lubrication
- | There is no longer any need to set or readjust the bearing during servicing



DUST CAP WITH INTEGRATED SEAL

A soft polymer is used between the hub and dust cap to provide a sealing function and additional protection for the bearing.

PLUS OPTIMA UNBRAKED AXLE

750 kg, 100x4, 112x5

Technology

Model: UBR 700
Axle type: 700-5
Axle load: EA 750 kg
Suspension: Hexagonal rubber suspension
Swing arm length: 145mm
Wheel connection: 100x4, 112x5
Wheel bearing: **Compact bearing**
Centre hole rim: min. 57 mm

Scope of supply

Loose wheel bolts

Surface treatment

Hot-dip galvanised axle beam



Part overview - available from January 2015 onwards

| OHF in mm | BC in mm | Single axle | | | | 100x4 | 112x5 | - | 50 | 10 |
|--------------|-------------|--|--|--|--|-------|-------|---|----|----|
| | | Wheel bolts Taper M12x1.5 100x4 Axle cpl. | Wheel bolts Taper M12x1.5 112x5 Axle cpl. | Wheel bolts Taper M12x1.5 100x4 Watertight axle cpl. | Wheel bolts Taper M12x1.5 112x5 Watertight axle cpl. | | | | | |
| 1130 | 700 | 200 596 01 | 200 596 48 | 200 600 01 | 200 600 25 | 17 | 20 | - | 50 | 10 |
| 1180 | 750 | 200 596 02 | 200 596 49 | 200 600 02 | 200 600 26 | 17 | 20 | - | 50 | 10 |
| 1230 | 800 | 200 596 03 | 200 596 50 | 200 600 03 | 200 600 27 | 18 | 20 | - | 50 | 10 |
| 1280 | 850 | 200 596 04 | 200 596 51 | 200 600 04 | 200 600 28 | 18 | 21 | - | 50 | 10 |
| 1330 | 900 | 200 596 05 | 200 596 52 | 200 600 05 | 200 600 29 | 18 | 21 | - | 50 | 10 |
| 1380 | 950 | 200 596 06 | 200 596 53 | 200 600 06 | 200 600 30 | 18 | 21 | - | 50 | 10 |
| 1430 | 1000 | 1 422 671 | 200 596 54 | 200 600 07 | 200 600 31 | 19 | 21 | - | 50 | 10 |
| 1480 | 1050 | 200 596 07 | 200 596 55 | 200 600 08 | 200 600 32 | 19 | 22 | - | 50 | 10 |
| 1530 | 1100 | 200 596 08 | 200 596 56 | 200 600 09 | 200 600 33 | 19 | 22 | - | 50 | 10 |
| 1580 | 1150 | 200 596 09 | 200 596 57 | 200 600 10 | 200 600 34 | 19 | 22 | - | 50 | 10 |
| 1630 | 1200 | 200 596 10 | 200 596 58 | 200 600 11 | 200 600 35 | 19 | 22 | - | 50 | 10 |
| 1680 | 1250 | 200 596 11 | 200 596 59 | 200 600 12 | 200 600 36 | 20 | 22 | - | 50 | 10 |
| 1730 | 1300 | 200 596 12 | 200 596 60 | 200 600 13 | 200 600 37 | 20 | 23 | - | 50 | 10 |
| 1780 | 1350 | 200 596 13 | 200 596 61 | 200 600 14 | 200 600 38 | 20 | 23 | - | 50 | 10 |
| 1830 | 1400 | 200 596 14 | 200 596 62 | 200 600 15 | 200 600 39 | 20 | 23 | - | 50 | 10 |
| 1880 | 1450 | 200 596 15 | 200 596 63 | 200 600 16 | 200 600 40 | 20 | 23 | - | 50 | 10 |
| 1930 | 1500 | 200 596 16 | 200 596 64 | 200 600 17 | 200 600 41 | 21 | 23 | - | 50 | 10 |
| 1980 | 1550 | 200 596 17 | 200 596 65 | 200 600 18 | 200 600 42 | 21 | 24 | - | 50 | 10 |
| 2030 | 1600 | 200 596 18 | 200 596 66 | 200 600 19 | 200 600 43 | 21 | 24 | - | 50 | 10 |
| 2080 | 1650 | 200 596 19 | 200 596 67 | 200 600 20 | 200 600 44 | 21 | 24 | - | 50 | 10 |
| 2130 | 1700 | 200 596 20 | 200 596 68 | 200 600 21 | 200 600 45 | 21 | 24 | - | 50 | 10 |
| 2180 | 1750 | 200 596 21 | 200 596 69 | 200 600 22 | 200 600 46 | 22 | 24 | - | 50 | 10 |
| 2230 | 1800 | 200 596 22 | 200 596 70 | 200 600 23 | 200 600 47 | 22 | 25 | - | 50 | 10 |
| 2280 | 1850 | 200 596 23 | 200 596 71 | 200 600 24 | 200 600 48 | 22 | 25 | - | 50 | 10 |

Clamping clip for drawbar tube $\varnothing 60$

Part no. 267 395

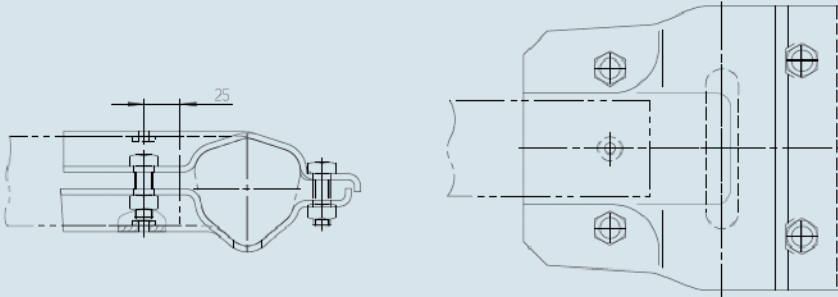

Single axle

